

INKJET CODE Description : XX X XX XX

XX-YEAR: 20 = 2020
 X-MONTH: A = JAN, B = FEB,.....
 XX-DAY: 14 = 14th DAY
 XX-HOUR: 14 = 14 PM

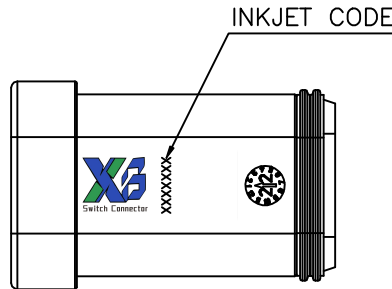
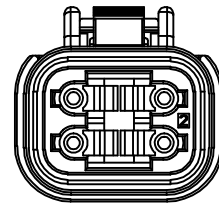
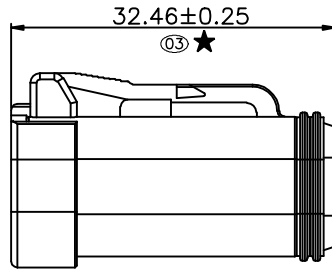
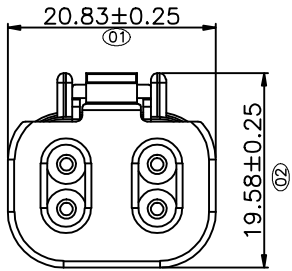

Specifications

Current Rating 14 AWG: 13.0Amp AC/DC
 16 AWG: 13.0Amp AC/DC
 18 AWG: 10.0Amp AC/DC
 20 AWG: 7.5Amp AC/DC

Voltage Rating: 250V AC/DC.
 Insulation Resistance:1000MΩMin.
 Dielectric Withstanding Voltage:1500VAC
 Contact Resistance:20mΩMax.
 Operating Temperature:-55°C to +125°C
 Materials

Insulator Material:High Temperature Thermoplastic, UL 94V-0 PA66 or the equivalent material

★ All materials must meet Greenconn hazardous substances control standards.

★★: Critical Characteristics. indicates product characteristics, functionalities, and manufacturing processes regarding to customer's specifications

★☆: Safety Features indicates product characteristics, functionalities, and manufacturing processes complying to legal regulations stated by local government

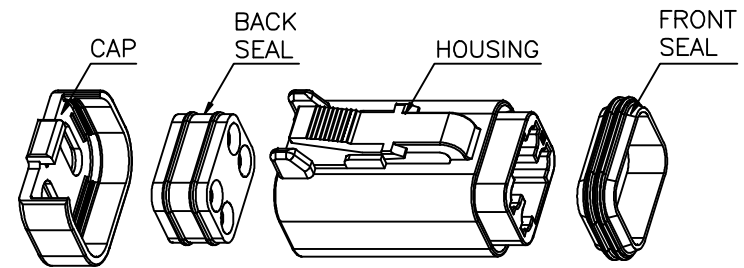

东莞市溪榜电子有限公司
 DONG GUAN XI BANG ELECTRONIC CO., LTD.
 Switch Connector

REV. A	UNIT. mm	SCALE. 3:2	PAGE. 1/1
--------	----------	------------	-----------

3RD.ANG PROJ.

GENERAL TOLERANCE	
X.*±3.0"	X.±0.30
.X'±2.0"	.X±0.25
.XX'±1.0"	.XX±0.20
.XXX'±0.5"	.XXX±0.15

DESIGNED:	DATE:
CHECKED:	DATE:
APPROVED:	DATE:

DWG. NO.	XB-AGZ131-04APA
PART NO.	XB-AGZ131-04APA

TITLE.	4 WAY PLUG STANDARD SEAL DT SERIES
--------	------------------------------------