

REV	DESCRIPTION	DESIGN	DATE
A0	Release	-	-

名称	DIM=A	DIM=B
L066K-01		B=4.50
L066K-02	A=4.00	B=8.50
L066K-03	A=8.00	B=12.50

**主要技术参数 Main Specifications**

线 数 (Poles): 01~03  
 适用线规 (Applicable Wire): 24~22#  
 接触电阻 (Contact resistance):  $\leq 20m\Omega$   
 绝缘电阻 (Insulation resistance):  $\geq 1000M\Omega$   
 额定电压 (Rated voltage): 275V AC DC  
 额定电流 (Rated current): 1A AC DC  
 耐 电压 (Withstand Voltage): 1000V AC/minute  
 温度范围 (Temperature Range):  $-40^{\circ}C \sim +110^{\circ}C$

**ORDER INFORMATION:**

**XB-L066K-\*\*-B1MA1-P**

PART No. _____	PACKAGING: P=PE
No. OF CIRCUITS: 01~03	PLATING: I=PhosphorBronze
PLASTIC MATERIAL: _____	PLATING: A=Sn
B1M=PA46 (BEIGE)	

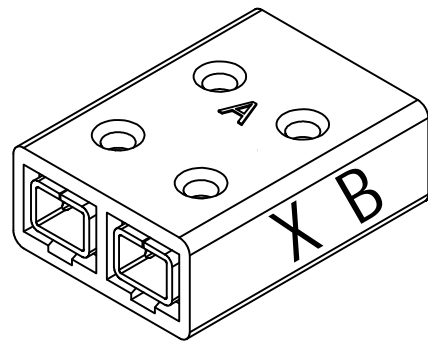
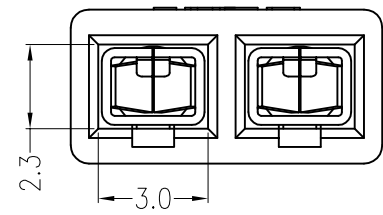
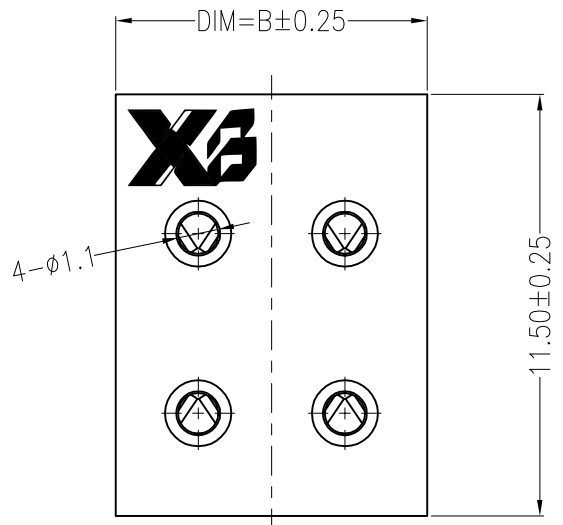
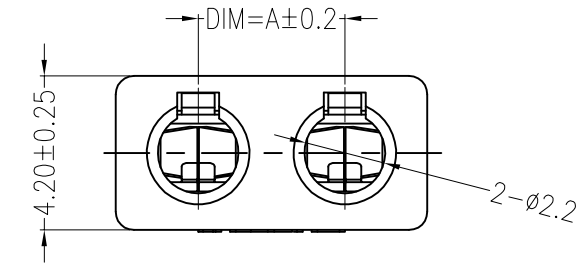

C				
B	CONTACT	1~3 PCS	PhosphorBronze	Sn-plated
A	PEDESTAL	1 PCS	PA46	UL 94V-0, COLOR:BEIGE
ITEM	COMPONENT	Q'TY	MATERIAL	FINISH

**东莞市溪榜电子有限公司**  
 Switch Connector DONG GUAN XI BANG ELECTRONICS CO., LTD

TITLE: -  
4.0mmPITCH

X.±0.5	X.±5'	USE: CUSTOMER	PART NO.: L066K-**-B1MA1-P
.X±0.3	.X±2'		
.XX±0.25	.XX±1'	APPD: 邵敬和	DWG NO.: GCCP-0379
--	--	CHKD: 田峰	
		DR: 吴丹平	SCALE: 1 : 1
	UNITS: mm		SHEET: 1 / 1