

Unit: mm

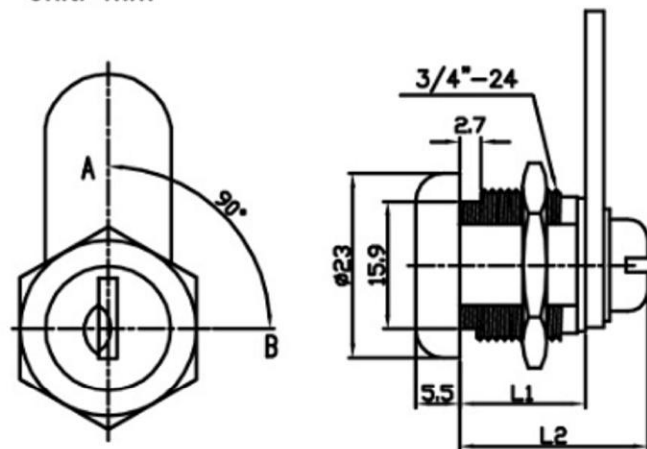
ROHS

Fig.1

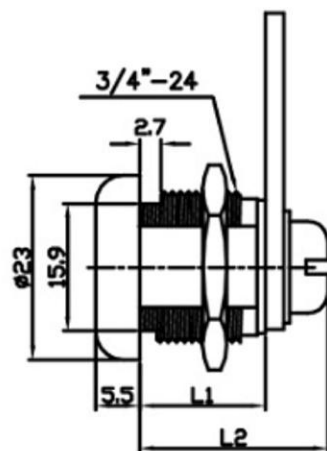
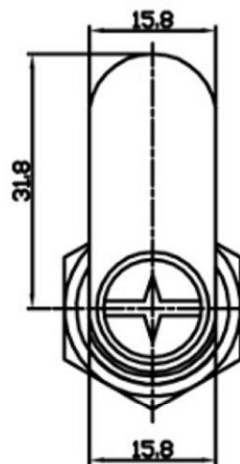
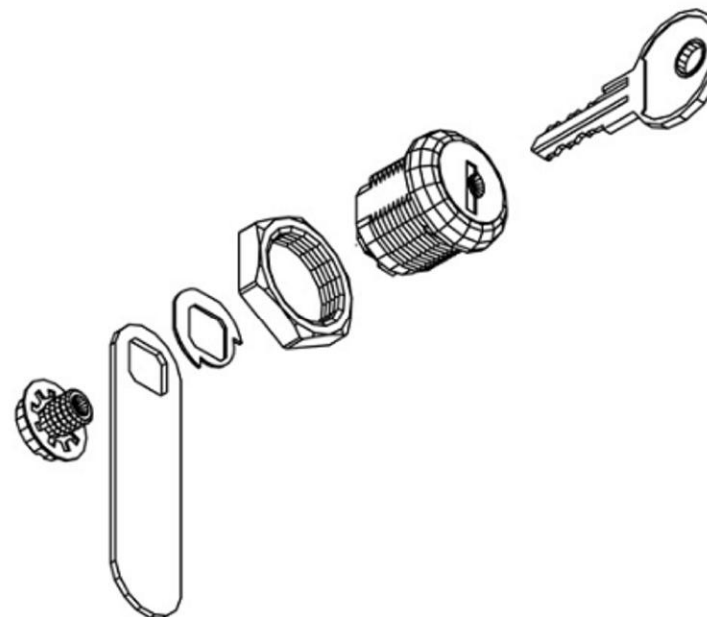


Fig.2



Recommended hole size



Mechanical key switch

Zinc alloy die cast housing and cylinder.

Stainless steel capped bezel

with dust shutter mechanism.

Yellow chromate plated standard.

5 disc tumbler mechanism.

Reversible double-bitted brass keys, nickel plated.

Cam is affixed by screw or fixed.

Hex nut or speed clip mounted.

Master keying is available.

Fig No	Lock Number	Positions	Key Pulls	Turn
1	C626S-1-D	2	1	90°
1	C626M-1-D	2	1	90°
1	C626XL-1-D	2	1	90°
2	C626S-2-D	2	2	90°
2	C626M-2-D	2	2	90°
2	C626XL-2-D	2	2	90°

Sizes	SCREW		FIXED
	L1	L2	L2
S	15.9	23	19.3
M	22.2	29.4	
XL	35	42	

The material contained in this drawing is the property of XiBang. Any use other than that specifically authorized by XiBang is prohibited. The above drawing IS subjected to change for improvement without prior notice.



东莞市溪榜电子有限公司
DONG GUAN XI BANG ELECTRONICS CO., LTD

TITLE : XB KEY SWITCH ELECTRONIC LOCK

MODEL : XB-C-626-D



TOLERANCE
≤1.5mm±0.1
> 1.5mm±0.2
>10mm±0.3

ANGLE
±2°

UNIT	MM	DWN.	ZENQ. CHEN	DATE					
SCALE	3 : 1	CHK'D	PENG. GAO	DATE					
VBRSION	01	APPD.	FEI. LONG. HE	DATE					
NO.	PART NAME	MATERIAL	QTY.	FINISHING					

7	SPRING	STEEL WIRE	1	NATURE
6	STEEL BALL	STEEL	1	NATURE
5	BOARD	PHENOLIC RESIN	1	NATURE
4	CONTACT CLIP	PBS STRIP	2	Ag PLATED
3	FRAME	IRON STRIP	1	Ni PLATED
2	TERMINAL	BRASS STRIP	8	Ag PLATED
1	KNOB	POM	1	BLACK