

ROHS

| REV. | ECN. NO. | APPD. |
|------|----------|-------|
| | | |

注：设计时，请注意公头插入时的距离，防止公头插不到底。

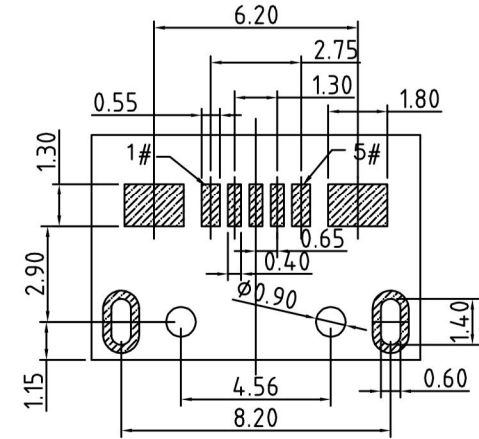
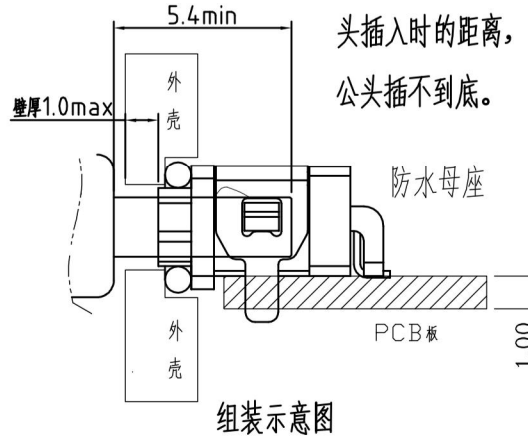
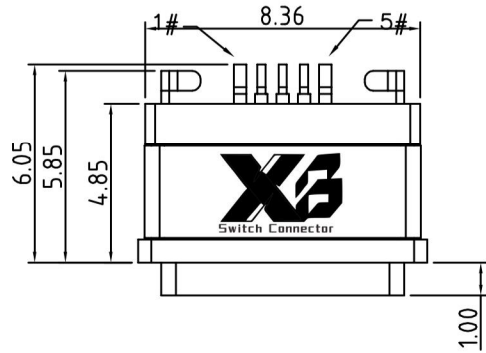

RECOMMENDED PCB LAYOUT(TOP VIEW)

THICKNESS T=1.0mm
DEFAULT TOLERANCE+/-0.05

SPECIFICATIONS:

- ELECTRICAL CHARACTERISTICS:
 - RATING: 3A(PIN1&5),0.5A(PIN2&3&4);
 - CONTACT RESISTANCE: 30 mΩ MAX.(INITIAL);
 - DIELECTRIC WITHSTANDING: 500V AC MIN.;
 - INSULATION RESISTANCE: 1000MΩ MIN.;
- DURABILITY: 5,000 CYCLES MIN.;
- INSERTION FORCE: 3.5Kgf (35N) Max.;
- EXTRACTION FORCE: 0.8Kgf (8N) Min.;
- WATER PROOFNESS: THIS PRODUCT IS BASED ON IPX8
- PLUG INTERFACE DIMENSIONS COMFORM TO USB2.0 SPEC.
- PACKAGING: TAPE & REEL.

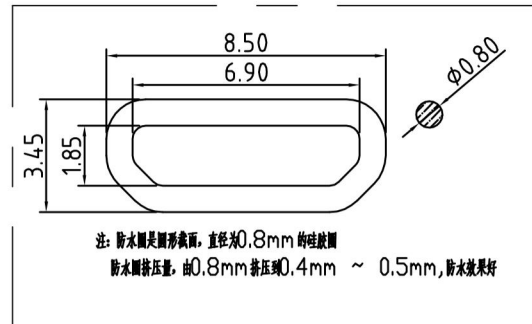
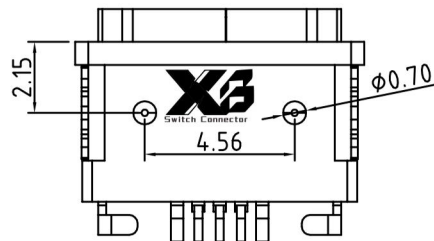
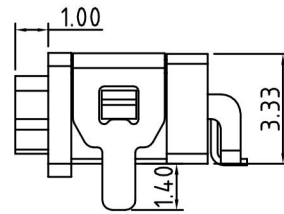
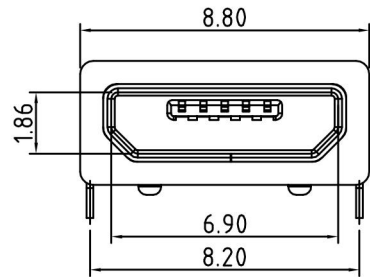

| Contact Number | Signal Name | Remarks |
|----------------|-------------|------------------|
| 1# | VBUS | Power |
| 2# | D- | Date- |
| 3# | D+ | Date+ |
| 4# | ID | Reserve or Gound |
| 5# | GND | Gound |

| 3 | Shell | 1 | SUS304R-1/2H Ni PlatingT=0.25mm | | | | | | | |
|-------|----------|-------------|---|---|-------|-------|------|-----|-----|----|
| 2 | Contact | 5 | Phosphor bronze C5191R-EH Au/Ni Plating T=0.20mm | | | | | | | |
| 1 | Housing | 1 | PA10T (G.F30%) | | | | | | | |
| ITEM | PARTNAME | Q'TY | FINISH | NOTE | | | | | | |
| X. | ±0.50 | X.* ± 2° | UNITS | 东莞市溪榜电子有限公司 DONG GUAN XI BANG ELECTRONICS CO., LTD | | | | | | |
| .X | ±0.30 | .X* ± 1° | mm | | | | | | | |
| .XX | ±0.10 | .XX* ± 0.5° | MAT'L | | | | | | | |
| .XXX | ±0.05 | | | | | | | | | |
| | | | FINISH | PART NO. XB-USB-M-5P-1197-IPX7 TITLE: Micro USB 5Pin SMT (B) Type (贴片插板) | | | | | | |
| | | | Q'TY | APPD: GAO. PENG CHKD: HE. LONG. FEI DR: PANG. DONG DWG NO: | | | | | | |
| | | | | <table border="1"> <tr> <th>SCALE</th> <th>SHEET</th> <th>REV.</th> </tr> <tr> <td>1/1</td> <td>1/1</td> <td>A1</td> </tr> </table> | SCALE | SHEET | REV. | 1/1 | 1/1 | A1 |
| SCALE | SHEET | REV. | | | | | | | | |
| 1/1 | 1/1 | A1 | | | | | | | | |